

# Uptown Understory

This planting is suited for yards that receive dappled sunlight. These plants thrive under the canopy of mature trees or buildings. The plants selected thrive in 4-6 hours or less of sunlight per day. Make this design pop by using more than one species of shrub and making one of these a specimen or wing planting. Just remember to always plant large woody plants at least 10 feet from your home and research their mature height and width prior to purchasing.

62-94 Total Plants

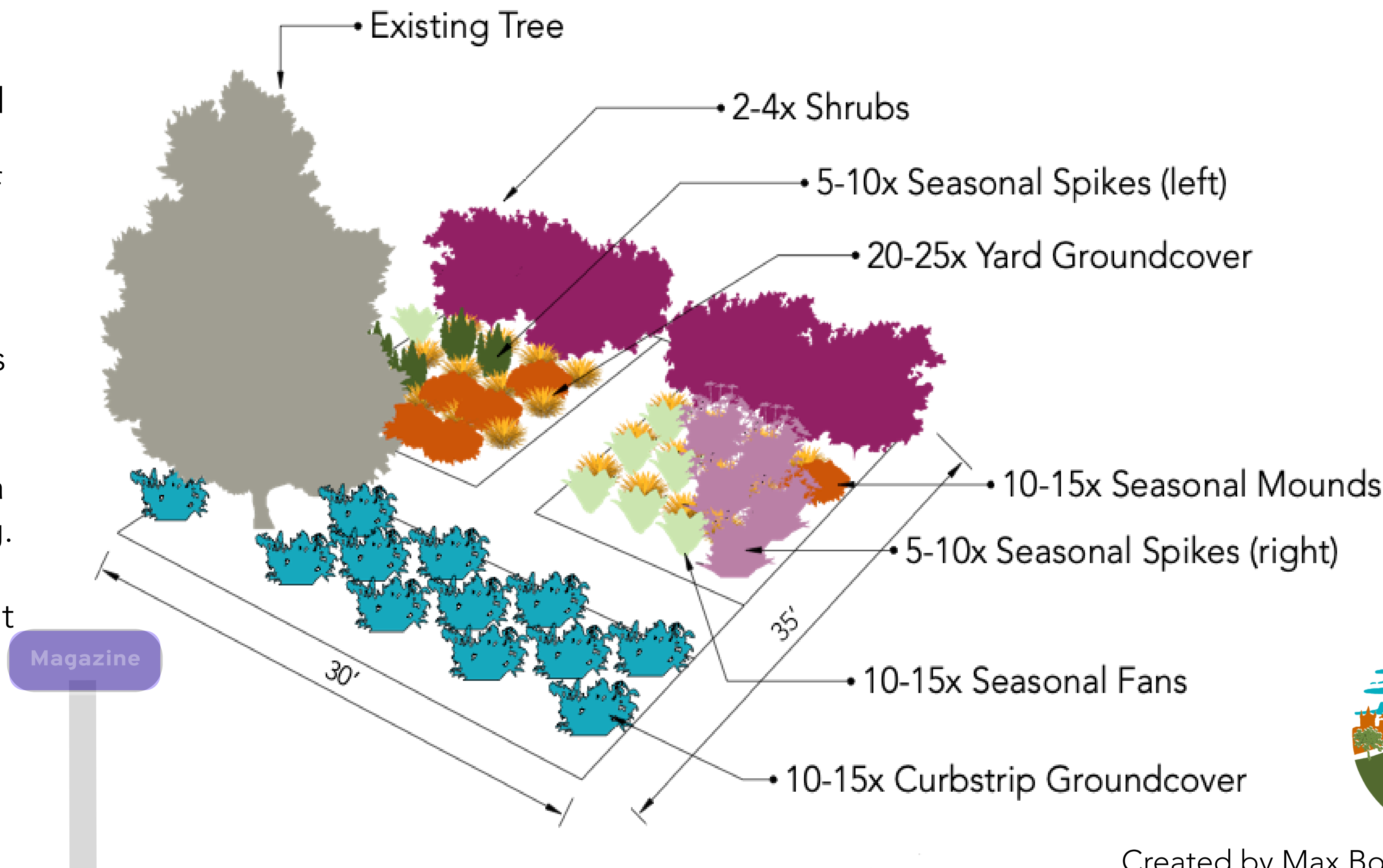

Created by Max Bowen-Koonse  
[www.npi-gno.org](http://www.npi-gno.org)

## Plant Selection: Uptown Understory

Choose one (or more) plant from each category

### 2-4x Shrubs/Small Trees

- Morella cerifera*, Wax Myrtle
- Viburnum dentatum*, Southern Arrowwood
- Viburnum nudum*, Possumhaw Viburnum
- Callicarpa americana*, American Beautyberry
- Sabal minor*, Dwarf Palmetto
- Malvaviscus arboreus* var. *drummondii*, Turk's Cap
- Rhododendron austrinum*, Florida Flame Azalea
- Erythrina herbacea*, Mamou
- Itea virginica*, Virginia Sweetspire
- Ilex decidua*, Deciduous Possumhaw
- Hydrangea quercifolia*, Oakleaf Hydrangea

### 10-15x Seasonal Fans

- Thelypteris kunthii*, Southern Shield Fern
- Spigelia marilandica*, Woodland Pinkroot
- Hibiscus aculeatus*, Pineland Hibiscus

### 10-20x Seasonal Spikes

- Rudbeckia subtomentosa*, Sweet Coneflower
- Asclepias perennis*, Aquatic Milkweed
- Echinacea purpurea*, Eastern Purple Coneflower
- Penstemon tenuis*, Gulf Coast Beardtongue
- Elephantopus carolinianus*, Carolina Elephantsfoot
- Vernonia gigantea*, Tall Ironweed
- Salvia coccinea*, Blood Sage
- Helianthus divaricatus*, Woodland Sunflower

### 10-15x Seasonal Mounds

- Symphyotrichum lateriflorum*, Calico Aster
- Conoclinium coelestinum*, Blue Mistflower
- Amsonia tabernaemontana*, Eastern Blue Star

### 20-25x Yard Groundcover

- Carex* spp., Sedge
- Phlox divaricata*, Wild Blue Phlox
- Sisyrinchium* spp., Blue-Eyed Grass
- Viola sororia*, Common Blue Violet
- Rudbeckia hirta*, Black Eyed Susan
- Phyla nodiflora*, Common Frogfruit
- Hypoxis hirsuta*, Eastern Yellow Stargrass
- Salvia lyrata*, Lyreleaf Sage

### 10-15x Curbstrip Groundcover

- Chasmanthium latifolium*, River Oats
- Carex cherokeensis*, Cherokee Sedge
- Carex flaccosperma*, Blue Wood Sedge
- Carex leavenworthii*, Leavenworth's Sedge
- Carex blanda*, Common Wood Sedge
- Carex amphibola*, Creek Sedge



Created by Max Bowen-Koonse  
[www.npi-gno.org](http://www.npi-gno.org)